

Remote Maintenance System

It is an application to facilitate communication between remote instructors and workers by interactive telecommunication "movies, sounds, and texts".

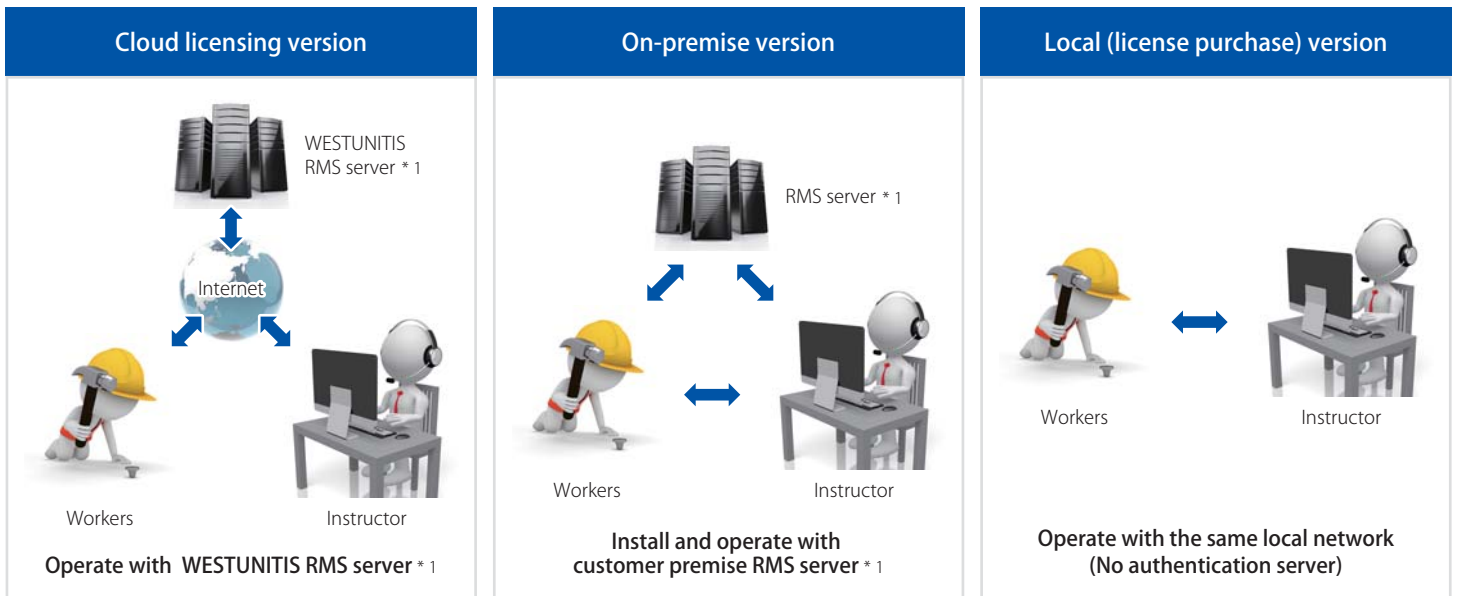

Service Plan * Please contact us for price quotes.



* 1 RMS stands for Remote Maintenance System.

Operating environment

PC
Windows® 10 / 8.1 / 7 (32bit / 64bit)
CPU1GHz or faster (2.4GHz or faster)
512 GB of RAM or higher (per an application)
1024 x 768 or higher display resolution

Authentication server
Windows Server 2012 or higher
CPU2GHz or faster

Android™
(Smartphone • Tablet)
Android 4.2.2 or higher
Compatible with various smart glasses

* Please contact us for the iPhone / iPad.



Application Study

- Automotive assemble line process checking
- Generator maintenance inspection
- Pharmaceutical production process managing
- Newcomer training etc

Working process details can be checked on the smart glass screen

- Characteristics**
- Hands free
 - Voice / Remote control operating
 - Paperless
 - Makes work report automatically

Task Navigation System

It is an application to support checking error and omission in complicated work process.

Service Plan * Please contact us for price quotes.

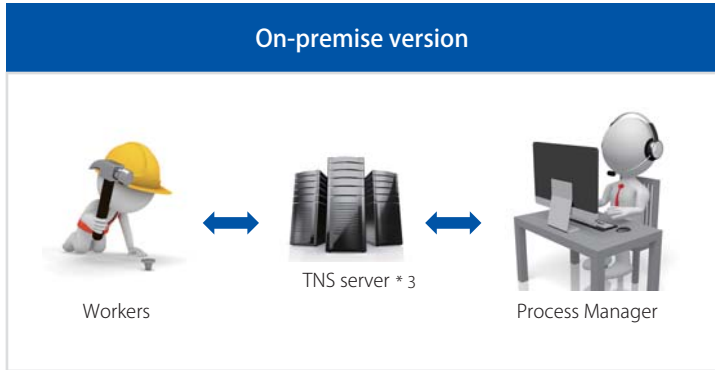
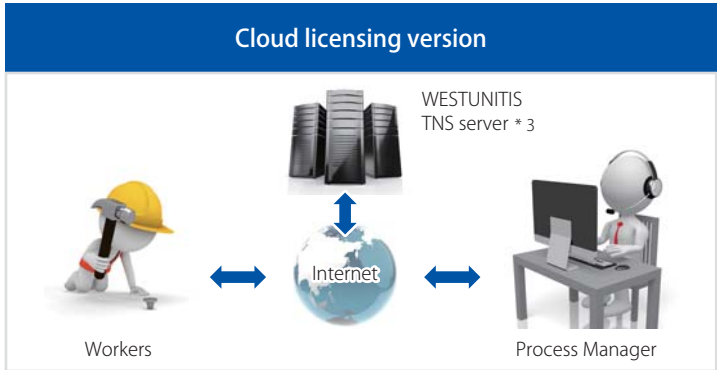

Operating environment

- Manager PC**
Windows® 10 / 8.1 / 7 (32bit / 64bit)
CPU 1GHz or faster (2.4GHz or faster)
- TNS server * 3**
Windows Server 2012 or higher
CPU 2GHz or faster

- Android™** (Smartphone • Tablet)
Android 4.2.2 or higher
- Compatible with various smart glasses
* Please contact us for the iPhone / iPad.

* 2 RMS stands for Remote Maintenance System. * 3 TNS stands for Task Navigation System.

● InfoLinker™ is a trademark of WESTUNITIS CO., LTD. ● Windows® is a registered trademark of Microsoft Corporation in the United States and/or other countries. ● Android is a trademark of Google Inc. ● iPhone and iPad are trademarks of Apple Inc., registered in the U.S. and other countries. ● Adobe Flash Player is either registered trademarks or trademarks of Adobe Systems Incorporated in the United States and/or other countries. ● All rights not specified in this manual belong to their owners.

InfoLinker™ Case set

It will only be used within the same network.



* Limit on the number. Please contact us for availability.

For more information about the RMS* 2 · TNS* 3, visit <https://www.westunitis.com>

WESTUNITIS CO., LTD.
29F Grand Front Osaka Tower-A, 4-20, Ofukacho, Kita-ku, Osaka, 530-0011, Japan
TEL : +81-6-6375-2831

Tokyo Office
4F Kokusai Building 3-1-1 Marunouchi, Chiyoda-ku, Tokyo, 100-0005, Japan
TEL : +81-3-6551-2471

Contact Information Japan : contact@westunitis.co.jp web : <https://www.westunitis.com> Others : contact@westunitis.com web : <https://www.westunitis.com>